

MAX-2

How to Install the MAX-2 Dräger® Replacement

STEP 1: Unscrew sensor housing cover; Remove sensor.

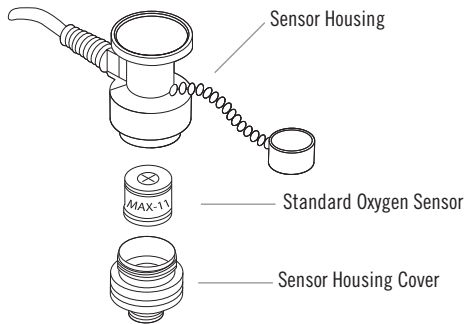

STEP 2: Thread the Maxtec® MAX-2 Extra-Life oxygen sensor into the sensor housing. Sensor housing cover is not required.

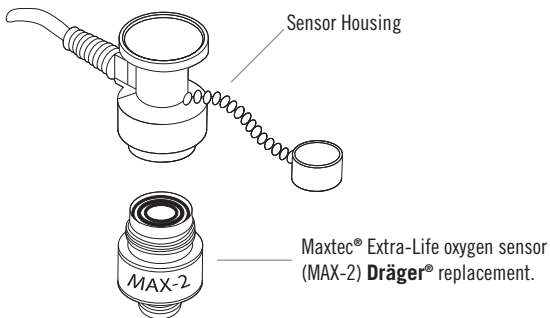

STEP 3: The Maxtec® sensor assembly can now be easily installed into the Dräger® Anesthesia Dome Assembly (save the dome for later use, if necessary).

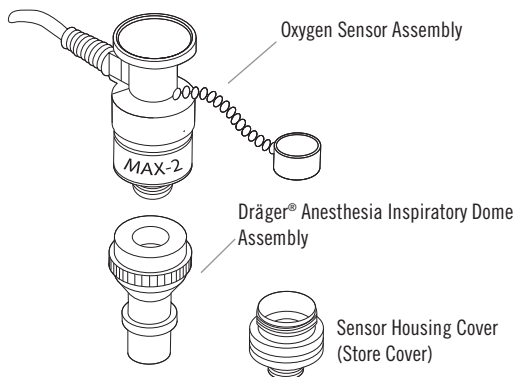

Dräger® is a registered trade name of its respective corporations. Maxtec® is not affiliated or endorsed by Dräger®

MAX-8

How to Install the MAX-8 Datex•Ohmeda Replacement

STEP 1: Unscrew sensor housing cover; Remove sensor.

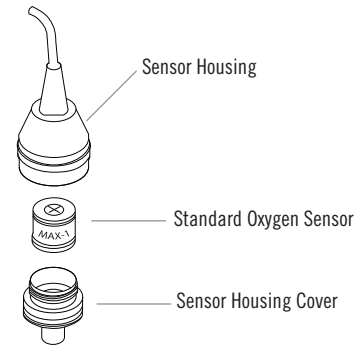

STEP 2: Thread the Maxtec® MAX-8 Extra-Life oxygen sensor into the sensor housing. Sensor housing cover is not required.

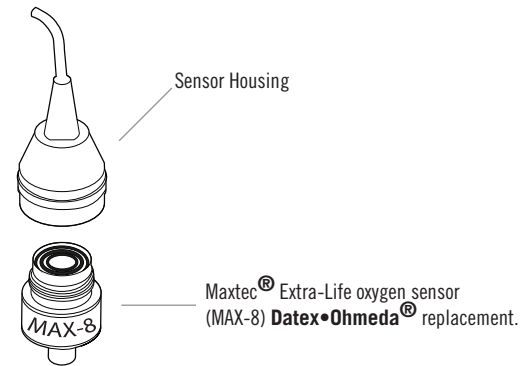

STEP 3: The Maxtec® sensor assembly can now be easily installed into the GMS absorber of the Datex•Ohmeda® Anesthesia machines.

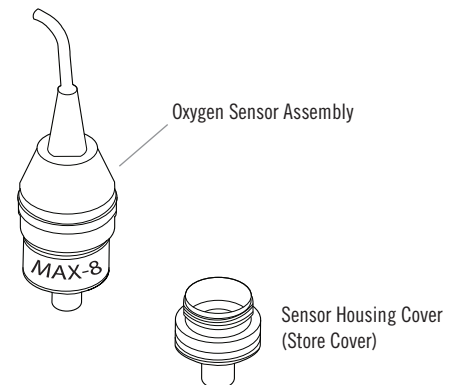

Datex•Ohmeda® is a registered trade name of its respective corporations. Maxtec® is not affiliated or endorsed by Datex•Ohmeda®

ML# 002 REV. E



6526 South Cottonwood Street
Salt Lake City, Utah 84107

866.4.Maxtec | www.maxtecinc.com